

PARA QUITAR LA BANDEJA:

- 1 Presione y sostenga el botón del conector de la bandeja

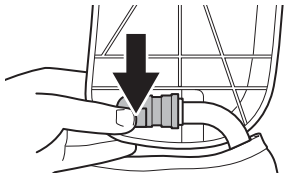

- 2 Use ambas manos para deslizar y soltar del conector la bandeja

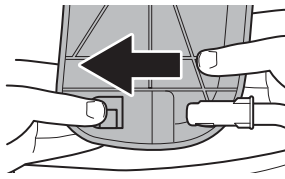

- 3

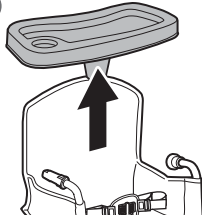

PARA QUITAR LA TELA:

- 1 Presione los pernos o pasadores de cierre y deslice los conectores para soltarlos del marco

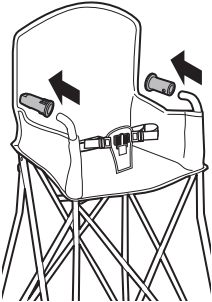

- 2 Deslice y levante la tela para soltarla del marco

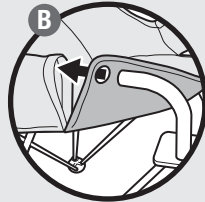
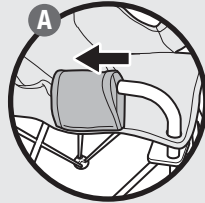
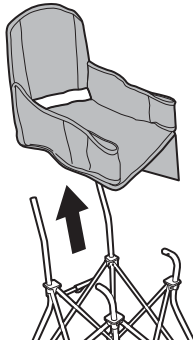

⚠ ADVERTENCIA

Tras el lavado, cerciéndose de que el asiento de tela Y TAMBIÉN los conectores deslizantes queden correctamente fijados al marco.

NOTA:

Invierta los pasos de esta sección para fijar nuevamente la tela al marco.

LIMPIEZA Y MANTENIMIENTO:

Revise la silla antes de cada utilización para detectar estructuras dañadas, juntas sueltas, piezas faltantes o bordes cortantes. No use esta silla si hubiera piezas rasgadas, rotas o faltantes.

- Marco: Frotar con un paño húmedo. Use jabón doméstico suave y agua caliente. Nunca use lejía o detergente.
- Tela y bolsita utilitaria: Quite del marco la tela. Cierre las hebillas de sujeción y ponga la tela en una bolsa de lavado. Lavar a máquina con agua fría, en ciclo suave. No usar lejía. No secar con centrifuga. Cuelgue la tela para secarla. No planchar. No llevar a una tintorería.
- Bandeja: Puede lavarse en el lavavajillas, exclusivamente en el estante superior.



Estamos deseosos de ayudarle!

Si tuviera cualquier pregunta o necesitara ayuda, comuníquese con nuestro Grupo de Relaciones con el Consumidor por el teléfono 1-401-671-6551 o el sitio web www.summerinfant.com/contact

Summer Infant (USA), Inc.

1275 Park East Drive
Woonsocket, RI 02895
1-401-671-6551

©2018 Summer Infant (USA), Inc.

Summer Infant Canada, Inc.

200 First Gulf Blvd., Unit C
Brampton, Ontario
Canada, L6W 4T5
1-905-456-8484

Mantenga a mano esta información para futuras consultas. Pueden variar los colores y estilos.

HECHO EN CHINA

11/18



22544, 22554

Please read the following instructions and warnings carefully.

Keep this instruction manual for future reference.

For product support, contact us at

1-401-671-6551 or www.summerinfant.com/contact

No tools required.

For use with children 6 months, up to 45 lbs.

Keep small parts out of child's reach.

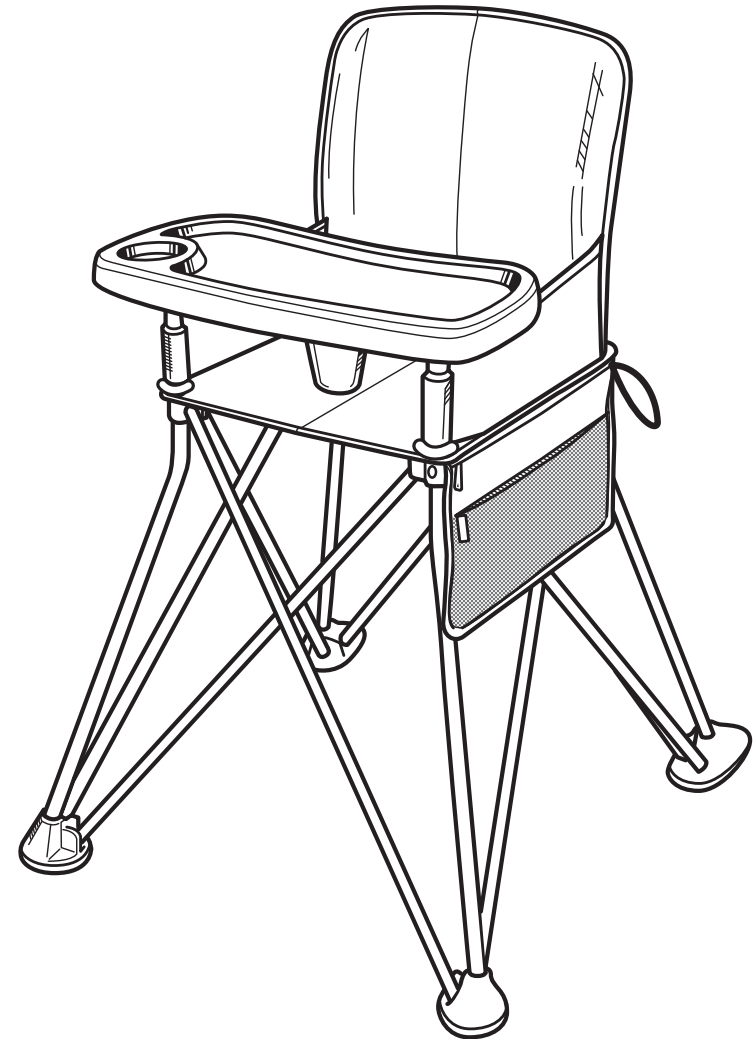

Pop 'n Dine™ SE Highchair

OWNER'S MANUAL

⚠ WARNING

FALL HAZARD: Children have suffered **severe** head injuries including skull fractures when falling from high chairs. Falls can happen suddenly if child is not restrained properly.

- Always use restraints, and adjust to fit snugly.
- Tray is not designed to hold the child in chair.
- Stay near and watch child during use.
- The child should be secured in the high chair at all times by the restraining system.
- It is recommended that the high chair be used only by children capable of sitting upright unassisted.

COMPONENTS:

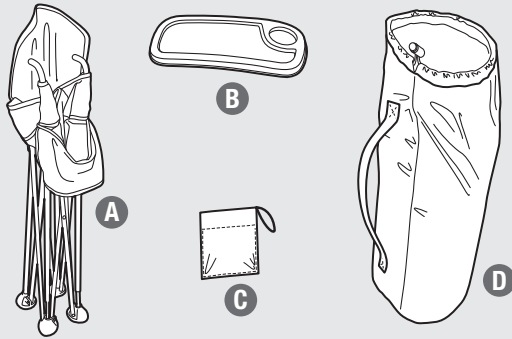

- A** Pop 'n Dine Highchair
- B** Tray
- C** Take-Along Pouch
- D** Carry Bag

Replacement Parts:

Tray:	22544-01
Tray Assembly Parts:	22544-02
Take-Along Pouch:	22544-03 (MANGO) 22554-03 (AQUA)
Carry Bag:	22544-04
Fabric Seat:	22544-05 (MANGO) 22554-05 (AQUA)

ASSEMBLY:

- 1** Extend legs then press down on the lock with your hand

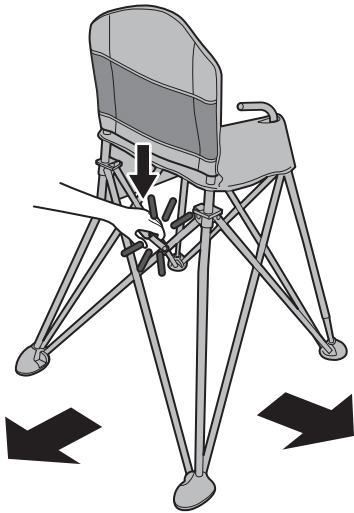

NOTE: Before use, ensure that the highchair is fully open and locked into position

- 2** Slide tray onto the connector

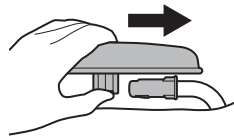

- 4** Rotate tray down until it locks

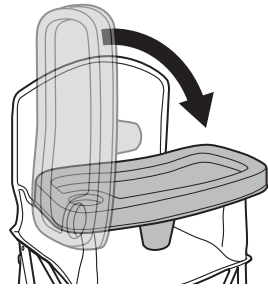

NOTE: Before use, ensure that the tray connection is secure

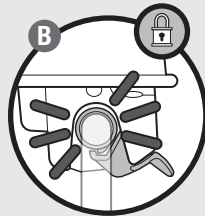
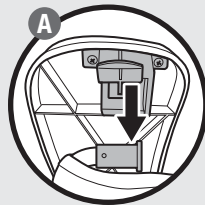
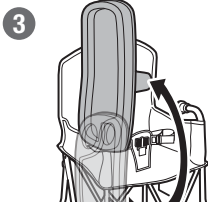

ASEGURAR/SOLTAR LA SUJECIÓN DEL NIÑO:

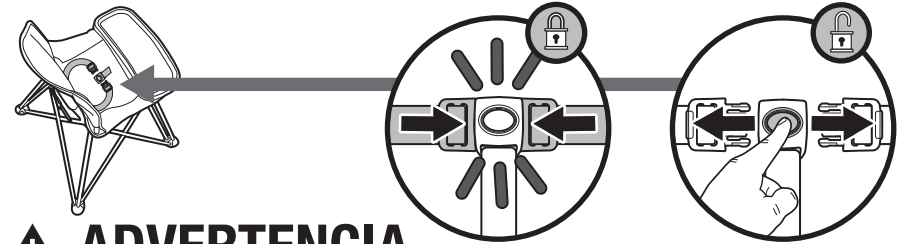

⚠ ADVERTENCIA Impida que el niño se lesione grave o fatalmente al caerse o resbalar del asiento. Use siempre el sistema de sujeción y ajústelo firmemente.

ALMACENAMIENTO ADICIONAL:

Bolsita utilitaria

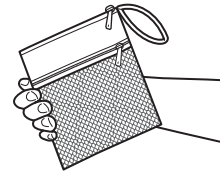

Sujete la bolsita a la silla con el cierre de cremallera

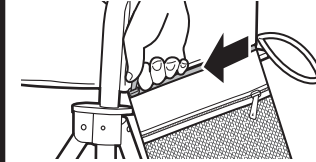

Bolsillo del respaldo

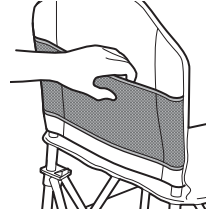

NOTA: No ponga mas de .5 lb (.27 kg) en la bolsita utilitaria o el bolsillo del respaldo.

PLEGAR LA BANDEJA Y LA SILLA CUANDO NO SE ESTÉN USANDO:

- 1** Empuje la bandeja hacia abajo y levante entonces el cierre

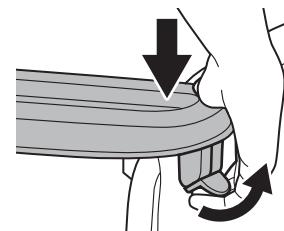

- 2** Pliegue la bandeja a un costado de la silla

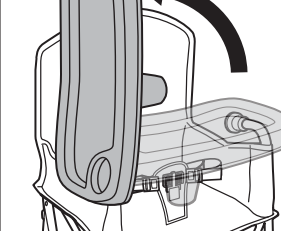

- 3** Pliegue la bandeja a un costado de la silla

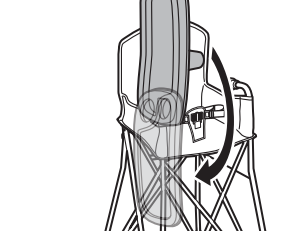

- 4** Para soltarla, mueva hacia afuera y hacia arriba la manilla de cierre que está en la parte de atrás de la silla

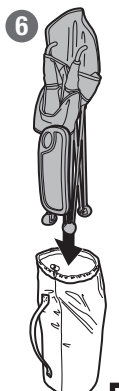
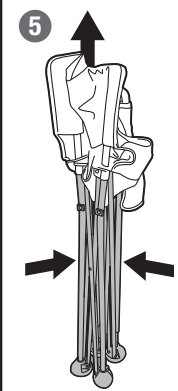
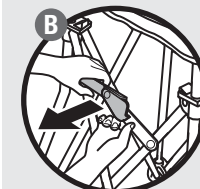
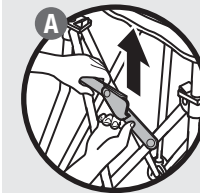
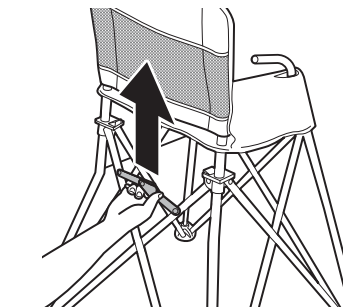

⚠️ ADVERTENCIA

PELIGRO DE CAÍDAS: Ha habido niños que han sufrido graves lesiones de la cabeza, incluidas fracturas de cráneo, al caerse de sillas altas. Las caídas pueden producirse de repente si el niño no está correctamente sujeto.

- Use siempre el sistema de sujeción y ajústelo firmemente.
- La bandeja no está diseñada para sujetar al niño en la silla.
- Manténgase cerca y vigile al niño cuando esté en la silla.
- El niño debe estar bien sujeto a la silla en todo momento mediante el sistema de seguridad.
- Se recomienda que la silla alta sólo debe usarse para niños capaces de sentarse correctamente sin ayuda ajena.

COMPONENTES:

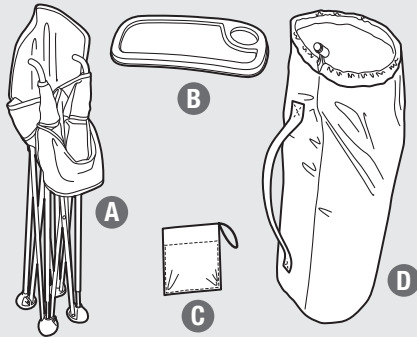

- A** Silla alta Pop 'n Dine
- B** Bandeja
- C** Bolsita utilitaria
- D** Bolsa para el traslado

Piezas de repuesto:

Bandeja:	22544-01
Piezas de ensamblaje de la bandeja:	22544-02
Bolsita utilitaria:	22544-03 (MANGO)
	22544-03 (AQUA)
Bolsa para el traslado:	22544-04
Asiento de tela:	22544-05 (MANGO)
	22544-05 (AQUA)

ENSAMBLAJE:

- 1** Despliegue las patas y use la mano para empujar el cierre hacia abajo

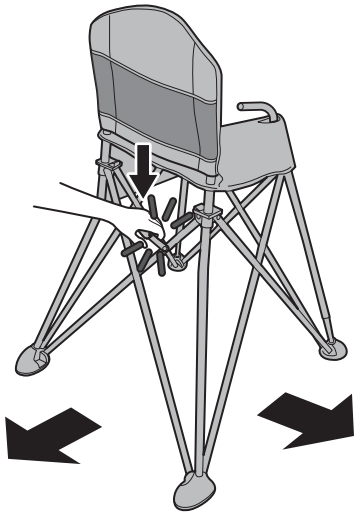

NOTA: Antes de usarla, cerciórese de que la silla alta esté desplegada por completo y bien asegurada en la posición correcta

- 2** Deslice la bandeja hacia el conector

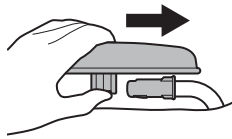

3

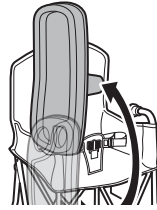

- 4** Rote la bandeja hacia abajo hasta que encaje en su sitio

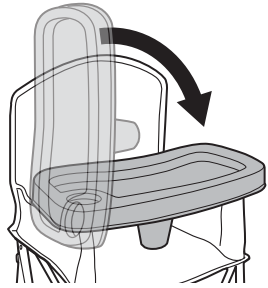

NOTA: Antes de usarla, cerciórese de que la conexión de la bandeja esté bien asegurada

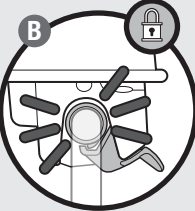
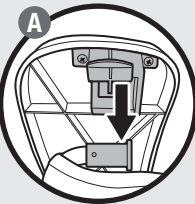

LOCKING/UNLOCKING CHILD RESTRAINT:

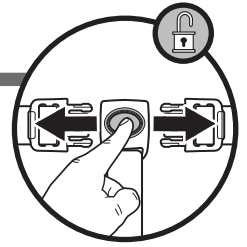
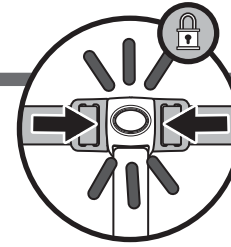

⚠️ WARNING

Prevent serious injury or death from falls or sliding out. Always use restraint system and adjust to fit snugly.

EXTRA STORAGE:

Take-Along Pouch

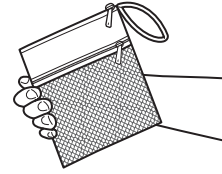

Zipper the Take-Along Pouch to highchair

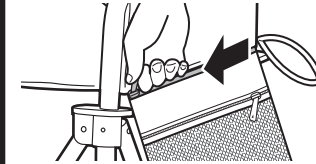

Backrest Storage Pocket

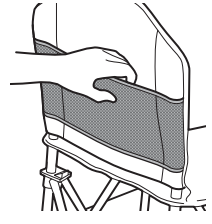

NOTE: Do not place more than .5 lbs (.27 kg) in the storage pocket or pouch.

FOLDING TRAY/CHAIR BETWEEN USE:

- 1** Press down on tray, then lift release lock up

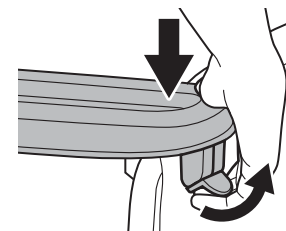

2

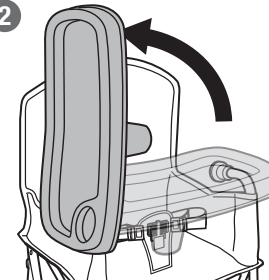

- 3** Fold tray alongside chair

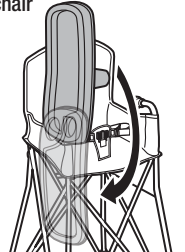

- 4** Pull out and up on release handle in back of highchair to unlock

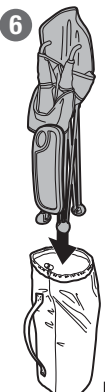
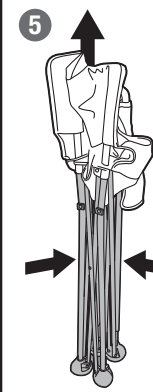
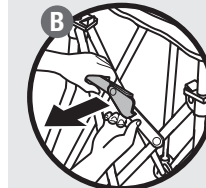
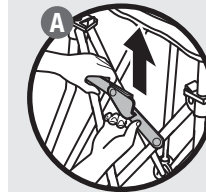
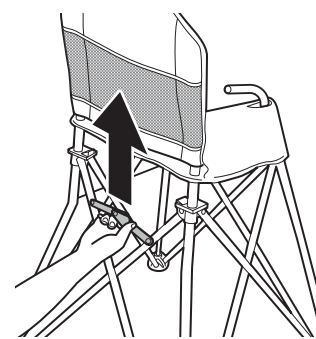

TRAY REMOVAL:

- 1 Press and hold button on tray connector

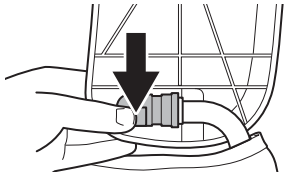

- 2 Slide tray off connector with both hands

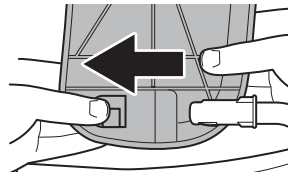

3

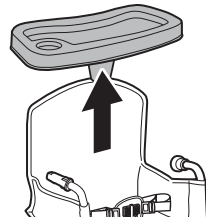

FABRIC REMOVAL:

- 1 Press locking pins and slide connectors off the frame

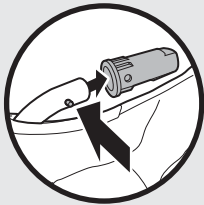
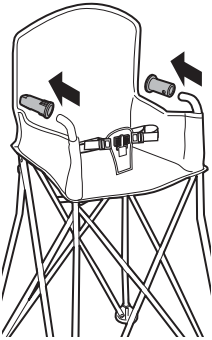

- 2 Slide and lift fabric off of frame

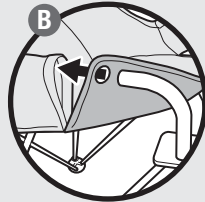
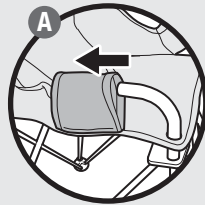
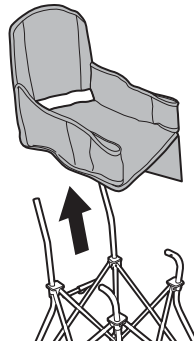

⚠ WARNING

After washing, ensure that the fabric seat AND slide connectors are properly and securely re-attached to frame.

NOTE:

Reverse steps from this section to re-attach fabric to frame.

CLEANING AND MAINTENANCE:

Before each use, inspect the highchair for damaged hardware, loose joints, missing parts or sharp edges. Do not use highchair if any parts are torn, broken, or missing.

- Frame: Wipe with damp cloth. Use mild household soap and warm water. Never use bleach or detergent.
- Fabric and Take-Along Pouch: Remove fabric from frame. Lock restraint buckles and place in a laundry bag. Machine wash cold, gentle cycle. Do not bleach. Do not tumble dry. Line or hang dry. Do not iron. Do not dry clean.
- Tray: Dishwasher safe, top rack only.



We're here to help!

If you have any questions or need assistance, contact our Consumer Relations Team at 1-401-671-6551 or www.summerinfant.com/contact

Summer Infant (USA), Inc.

1275 Park East Drive
Woonsocket, RI 02895
1-401-671-6551

©2018 Summer Infant (USA), Inc.

Summer Infant Canada, Inc.

200 First Gulf Blvd., Unit C
Brampton, Ontario
Canada, L6W 4T5
1-905-456-8484

Please retain information
for future reference
Colors and styles may vary.

MADE IN CHINA

11/18



22544, 22554

Lea atentamente las siguientes instrucciones y advertencias.

Guarde estas instrucciones para futuras consultas.

Para más información, comuníquese con nosotros por el teléfono 1-401-671-6551 o el sitio web www.summerinfant.com/contact

No se necesitan herramientas.

Apropiado para niños desde 6 meses; peso máximo de 20.4 kg (45 lb).

No deje las piezas pequeñas al alcance de los niños.

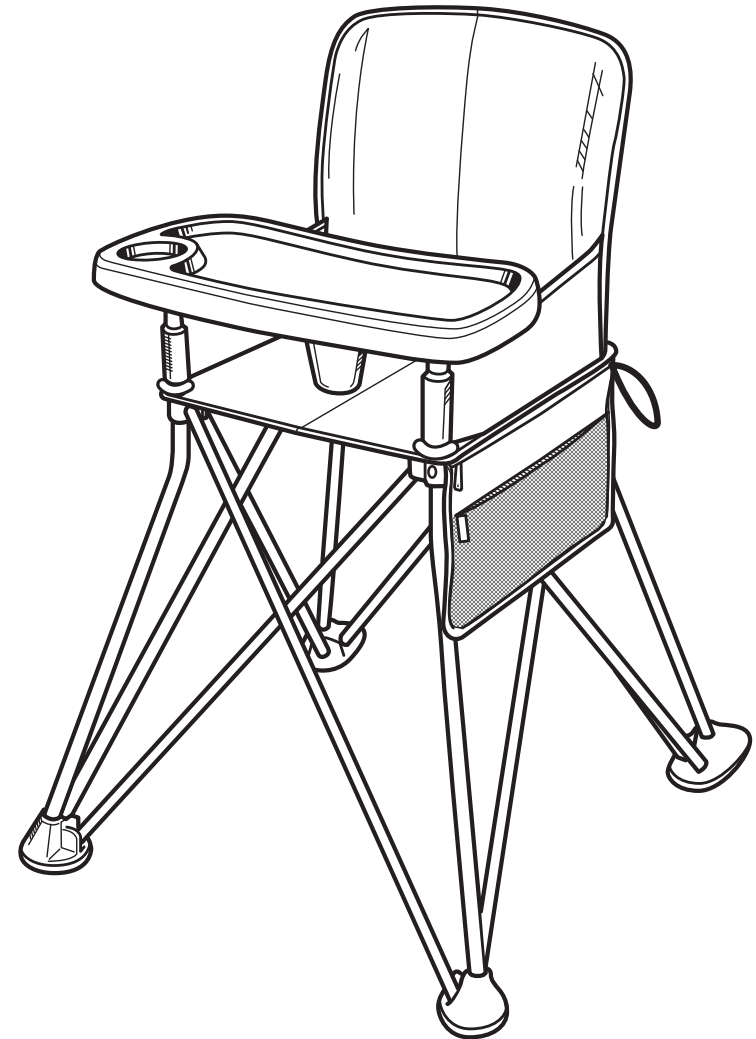

Silla alta Pop 'n Dine™ SE

MANUAL DEL PROPIETARIO

POUR RETIRER LE PLATEAU :

- 1 Appuyez sur le bouton du raccord coulissant du plateau et tenez-le enfoncé

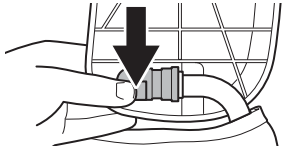

- 2 Utilisez les deux mains pour glisser et retirer le plateau

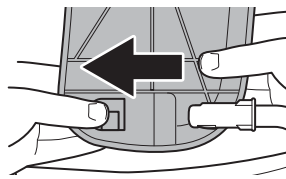

3

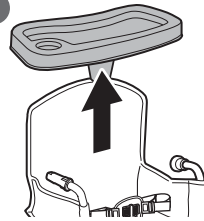

POUR RETIRER LE SIÈGE EN TISSU :

- 1 Appuyez sur les goupilles et glissez les raccords pour les retirer du cadre

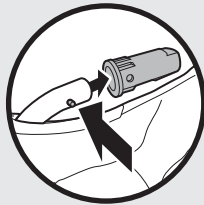
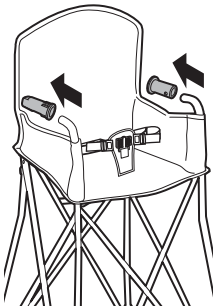

- 2 Glissez le tissu et retirez-le du cadre

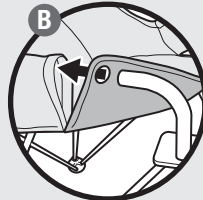
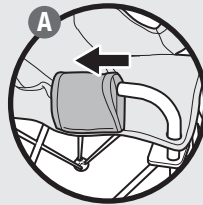
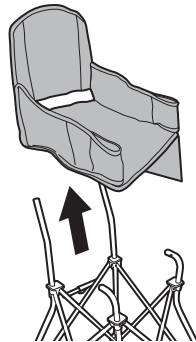

⚠ MISE EN GARDE

Une fois le tissu lavé, assurez-vous de bien fixer le siège ET les raccords coulissants au cadre.

NOTE:

Après le lavage, procédez dans l'ordre inverse pour fixer le tissu au cadre.

NETTOYAGE ET ENTRETIEN :

Avant chaque utilisation, inspectez la chaise haute à la recherche de pièces endommagées, de joints lâches, de pièces manquantes ou d'arêtes vives. N'utilisez pas la chaise haute si elle présente des pièces déchirées, brisées ou manquantes.

- Cadre : Essuyez à l'aide d'un chiffon humide. Utilisez de l'eau tiède et un détergent ménager doux. N'utilisez jamais de l'eau de Javel ou du détergent.
- Tissu et pochette amovible : Retirez le tissu du cadre. Verrouillez les boucles de retenue et placez-les dans un sac à linge. Lavez à l'eau froide, à cycle délicat. N'utilisez pas d'eau de Javel. Ne séchez pas par culbutage, mais suspendez ou séchez à plat. Pas de repassage ou de nettoyage à sec.
- Plateau : Lavable au lave-vaisselle, uniquement dans le panier supérieur.



Nous sommes là pour vous aider!

Si vous avez des questions ou avez besoin d'aide, communiquez avec notre équipe des relations clients :
1-401-671-6551 ou www.summerinfant.com/contact

Summer Infant (USA), Inc.
1275 Park East Drive
Woonsocket, RI 02895
1-401-671-6551
©2018 Summer Infant (USA), Inc.

Summer Infant Canada, Inc.
200 First Gulf Blvd., Unit C
Brampton, Ontario
Canada, L6W 4T5
1-905-456-8484

Veuillez conserver ce manuel
pour consultation future
Les couleurs et les styles peuvent varier.
FABRIQUÉE EN CHINE
11/18



22544, 22554

Veuillez lire attentivement les instructions et les avertissements qui suivent.
Conservez ce manuel d'instructions pour consultation future.
Pour obtenir du soutien relatif au produit, veuillez communiquer avec nous :
1-401-671-6551 ou www.summerinfant.com/contact

Aucun outil requis.

Pour enfants âgés de 6 mois et pesant 20,4 kg (45 lb) ou moins.

Garder les petites pièces hors de la portée des enfants.

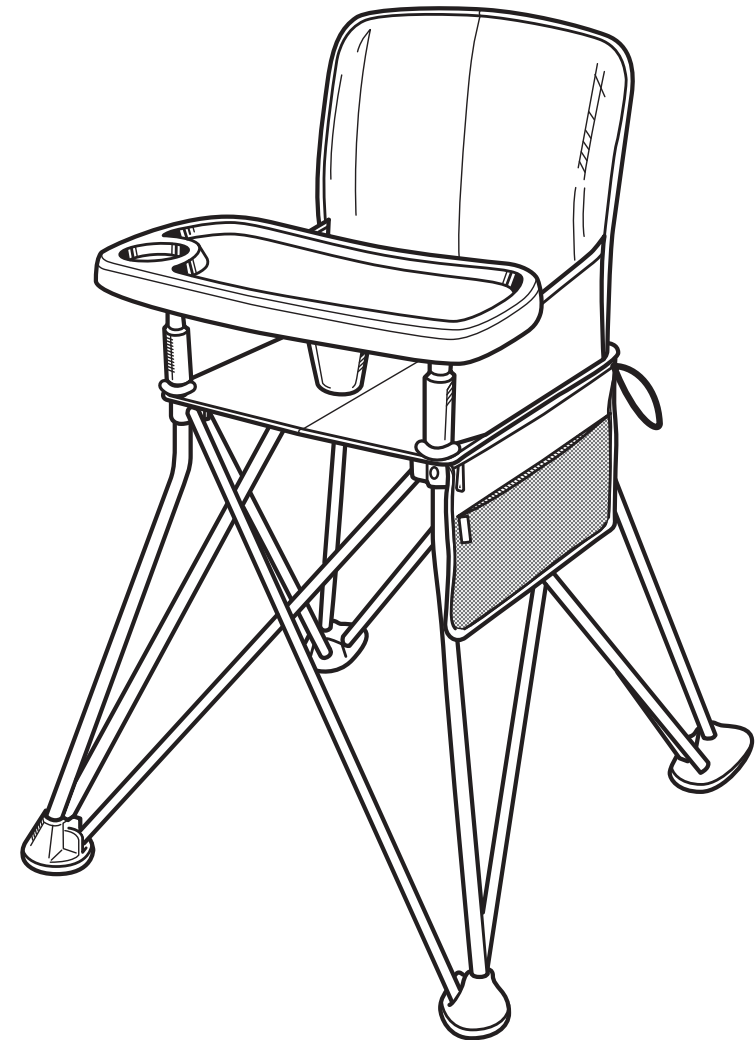

Chaise haute Pop 'n Dine™ SE

MANUEL DU PROPRIÉTAIRE

⚠ MISE EN GARDE

RISQUE DE CHUTE : Un enfant peut subir de graves blessures à la tête, dont des fractures du crâne, en tombant d'une chaise haute. Une chute peut survenir soudainement si l'enfant n'est pas bien attaché dans la chaise.

- Utilisez toujours les attaches et assurez-vous de bien les ajuster pour que l'enfant reste bien en place.
- Le plateau n'est pas conçu pour retenir l'enfant dans la chaise.
- Demeurez toujours près et gardez un œil sur l'enfant pendant qu'il est assis dans la chaise.
- Le système d'attaches doit être utilisé pour assurer que l'enfant est bien attaché dans la chaise en tout temps.
- Il est recommandé d'utiliser la chaise haute seulement avec un enfant capable de s'asseoir droit sans aide.

COMPOSANTES :

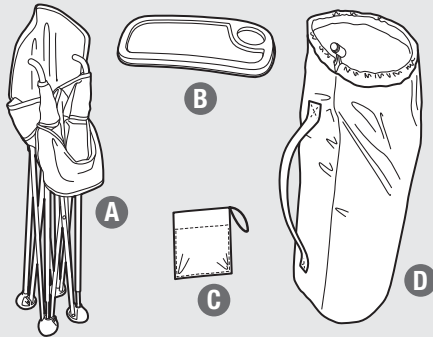

- A** Chaise haute Pop 'n Dine
- B** Plateau
- C** Pochette amovible
- D** Sac de transport

Pièces de Rechange :

Plateau :	22544-01
Pièces d'assemblage du plateau :	22544-02
Pochette amovible :	22544-03 (MANGUE)
	22544-03 (AQUA)
	22544-04
Sac de transport :	22544-05 (MANGUE)
Siège en tissu :	22544-05 (AQUA)

ASSEMBLAGE :

- 1** Étendez les pattes, puis utilisez votre main pour pousser vers le bas et les bloquer en place

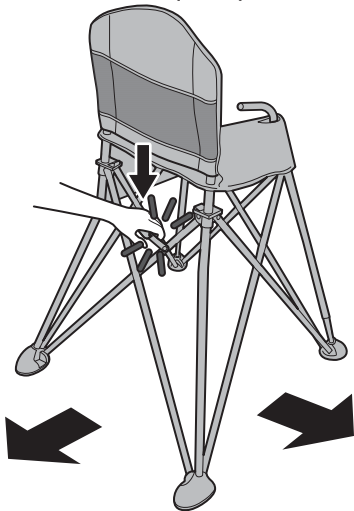

- 2** Glissez le plateau sur le connecteur

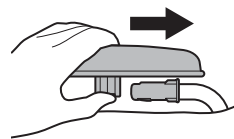

3

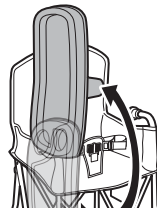

- 4** Faites pivoter le plateau vers le bas pour l'enclencher

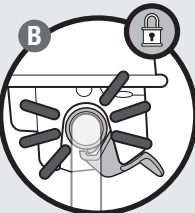
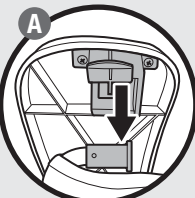
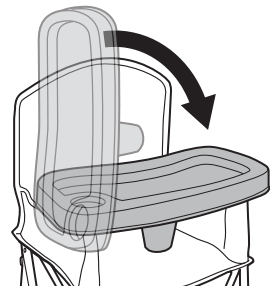

NOTE: Avant l'utilisation, assurez-vous que la chaise haute est pleinement déployée et en position bloquée

NOTE: Avant l'utilisation, assurez-vous que le plateau est fermement enclenché

VERROUILLAGE/DÉVERROUILLAGE DU DISPOSITIF DE RETENUE :

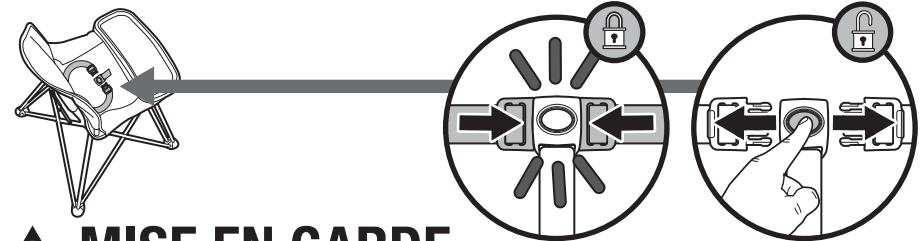

⚠ MISE EN GARDE Évitez les blessures graves ou fatales découlant de chutes. Utilisez toujours les attaches et assurez-vous de bien les ajuster pour que l'enfant reste bien assis dans la chaise.

ESPACES DE RANGEMENT SUPPLÉMENTAIRES :

Pochette amovible

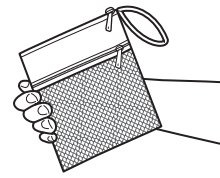

Utilisez la fermeture-éclair pour fixer la pochette amovible sur la chaise haute

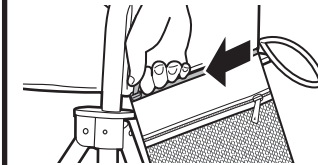

Pochette de rangement dans le dossier

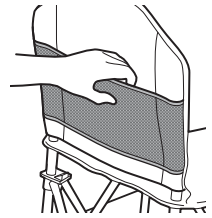

NOTE: Ne placez pas plus de 0,27 kg dans la pochette amovible ou pochette de rangement dans le dossier.

RANGEMENT DU PLATEAU ET DE LA CHAISE ENTRE LES UTILISATIONS :

- 1** Appuyez sur le plateau, puis poussez le dispositif de déverrouillage vers le haut

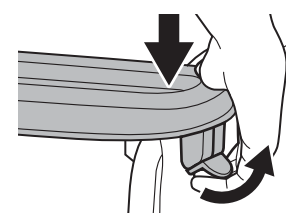

2

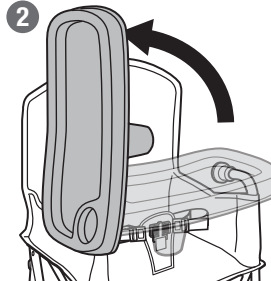

- 3** Rangez le plateau le long de la chaise

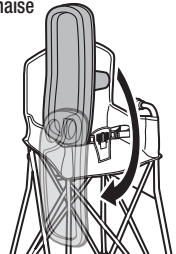

- 4** Tirez vers l'extérieur et vers le haut sur la poignée dans le dos de la chaise haute pour déverrouiller le mécanisme

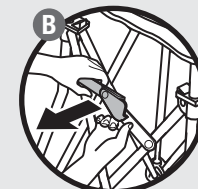
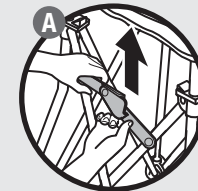
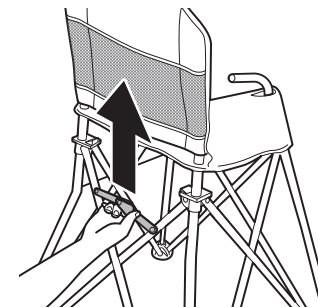

5

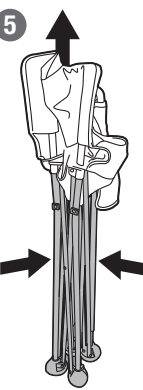

6

